

NPN Plastic-Encapsulate Transistor

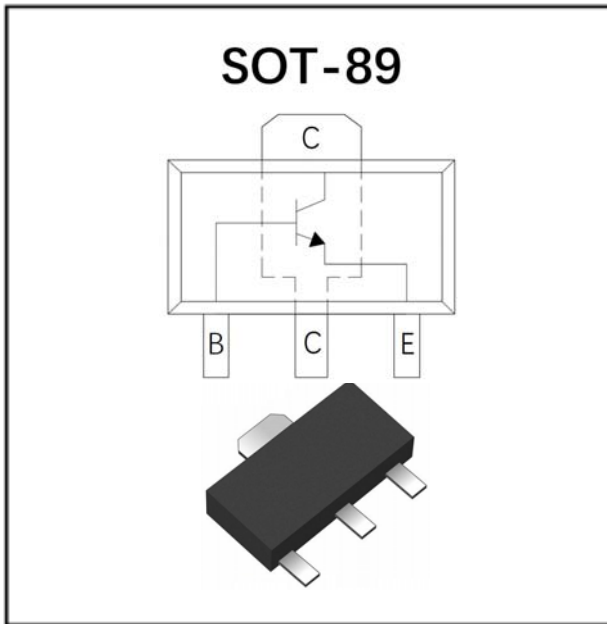

Features

- Epoxy meets UL-94 V-0 flammability rating
- Halogen free available upon request by adding suffix "HF"
- Moisture Sensitivity Level 1
- Low collector-emitter saturation voltage
- Part no. with suffix "Q" means AEC-Q101 qualified

Mechanical Data

- **Package:** SOT-89
- Molding compound meets UL 94 V-0 flammability rating, RoHS-compliant, halogen-free
- **Terminals:** Tin plated leads, solderable per J-STD-002 and JESD22-B102
- **Marking:** BL

■ Maximum Ratings (Ta=25°C unless otherwise noted)

Item	Symbol	Unit	Conditions	Value
Minimum Collector-Emitter Voltage	V_{CEO}	V	$I_C=10mA, I_B=0$	80
Minimum Collector-Base Voltage	V_{CBO}	V	$I_C=100\mu A, I_E=0$	100
Minimum Emitter-Base Voltage	V_{EBO}	V	$I_E=10\mu A, I_C=0$	5
Collector Current	I_C	A		1
Peak Collector Current	I_{CM}	A	single pulse, $t_p \leq 1ms$	2
Collector Power Dissipation (*)	P_C	mW		500
Operation Junction Temperature	T_j	°C		-55 to +150
Storage Temperature	T_{stg}	°C		-55 to +150

Item	Symbol	Unit	Min	Typ	Max
Thermal Resistance From Junction To Ambient (*)	$R_{\theta JA}$	°C/W		140	250

(*) Device mounted on FR-4 PCB 1.0 x 1.0 x 0.06 inch.



BCX56-16Q

■Electrical Characteristics (Ta=25°C unless otherwise noted)

Item	Symbol	Unit	Conditions	Min	TYP	Max
Collector-Emitter Voltage	V_{CE0}	V	$I_C=10mA, I_B=0$	80		
Collector-Base Voltage	V_{CBO}	V	$I_C=100\mu A, I_E=0$	100		
Emitter-Base Voltage	V_{EBO}	V	$I_E=10\mu A, I_C=0$	5		
Collector-Base cut-off current	I_{CBO}	nA	$V_{CB}=30V$			100
Emitter-Base cut-off current	I_{EBO}	nA	$V_{EB}=5V$			100
DC Current Gain	h_{FE}		$V_{CE}=2V, I_C=5mA$	40		
	h_{FE}		$V_{CE}=2V, I_C=150mA$	100		250
	h_{FE}		$V_{CE}=2V, I_C=500mA$	25		
Collector-Emitter Saturation Voltage	$V_{CE(sat)}$	V	$I_C=500mA, I_B=50mA$			0.5
Base-Emitter Voltage	V_{BE}	V	$V_{CE}=2V, I_C=500mA$			1
Transition Frequency	f_T	MHz	$I_C=10mA, V_{CE}=5V, f=100MHz$		130	

■Ordering Information (Example)

PREFERRED P/N	PACKING CODE	UNIT WEIGHT(g)	MINIMUM PACKAGE(pcs)	INNER BOX QUANTITY(pcs)	OUTER CARTON QUANTITY(pcs)	DELIVERY MODE
BCX56-16Q	F2	Approximate 0.055	1000	8000	32000	7" reel

■Characteristics (Typical)

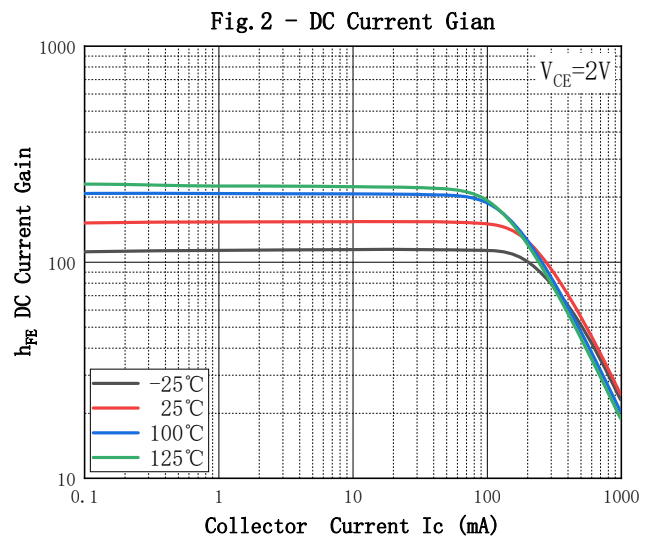
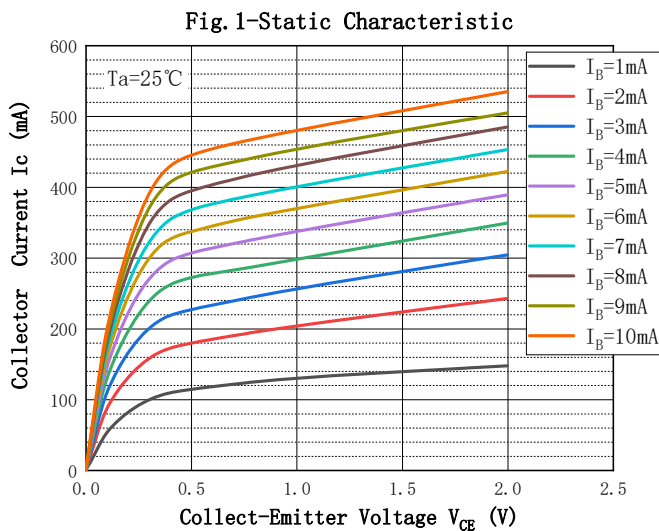



Fig. 3 - Collect-Emmitter Saturation Voltage

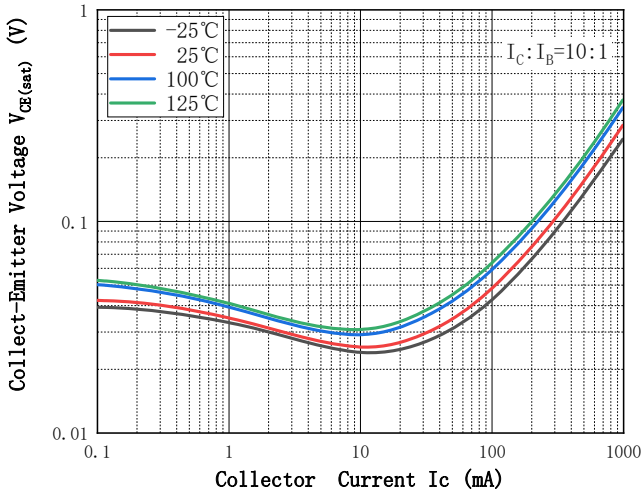

Fig. 4 - Base-Emmitter Voltage

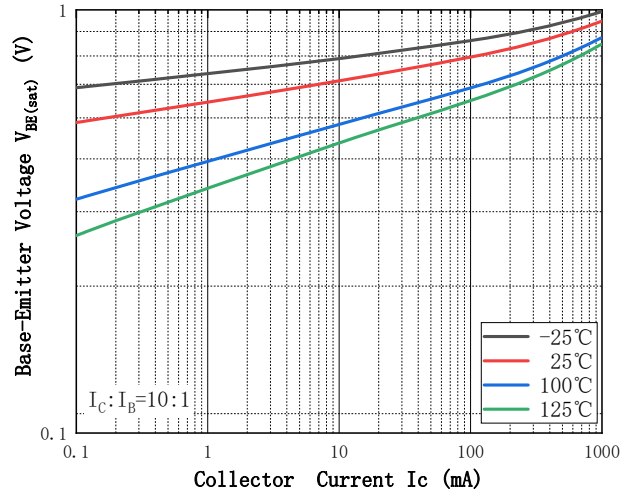

Fig. 5 - Base-Emmitter On Voltage

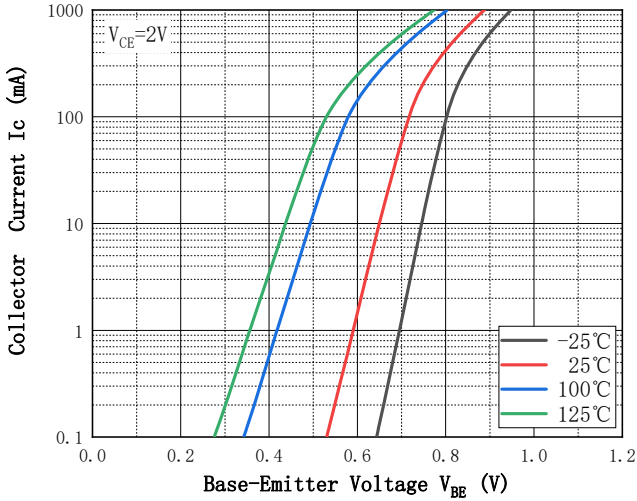

Fig. 6 - $C_{ob}/C_{ib} - V_{CB}/V_{EB}$

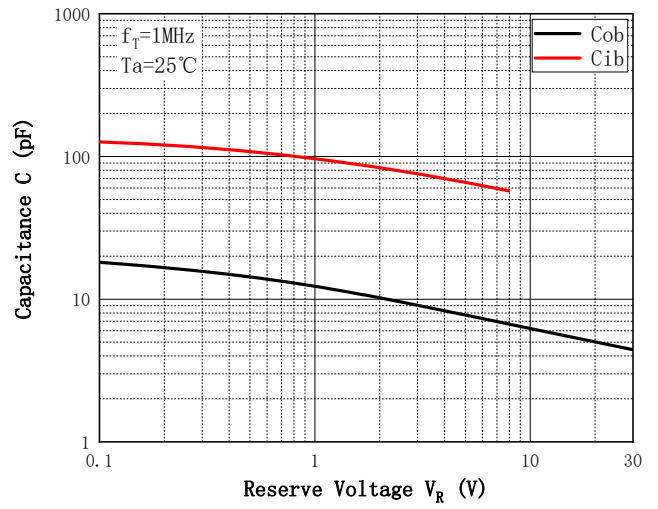
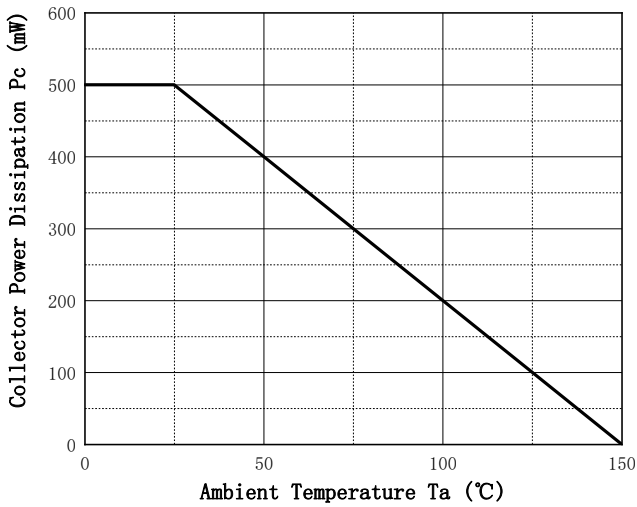

Fig. 7 - Collector Power Derating Curve





BCX56-16Q

■SOT-89 Package Outline Dimensions

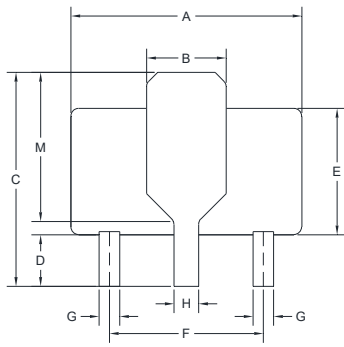

BOTTOM VIEW

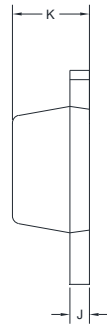

SIDE VIEW



SIDE VIEW

DIM	DIMENSIONS			
	INCHES		MM	
	MIN.	MAX.	MIN.	MAX.
A	0.173	0.181	4.400	4.600
B	0.061 TYP.		1.550 TYP.	
C	0.155	0.167	3.940	4.250
D	0.031	0.047	0.800	1.200
E	0.094	0.102	2.400	2.600
F	0.118 TYP.		3.00 TYP.	
G	0.014	0.019	0.360	0.480
H	0.017	0.022	0.440	0.560
J	0.014	0.017	0.350	0.440
K	0.055	0.063	1.400	1.600
L	0.059 TYP.		1.500 TYP.	
M	0.108 TYP.		2.750 TYP.	

■SOT-89 Suggested Pad Layout

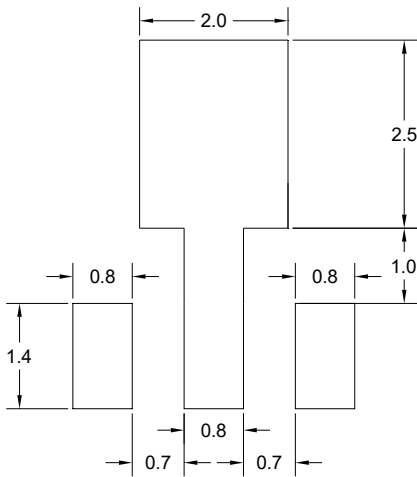

UNIT:MM

SUGGESTED SOLDER PAD LAYOUT



BCX56-16Q

Disclaimer

The information presented in this document is for reference only. Yangzhou Yangjie Electronic Technology Co., Ltd. reserves the right to make changes without notice for the specification of the products displayed herein to improve reliability, function or design or otherwise.

The product listed herein is designed to be used with automotive electronics, are not designed for use in medical, life-saving, lifesustaining, or military, Yangjie or anyone on its behalf, assumes no responsibility or liability for any damages resulting from such improper use of sale.

This publication supersedes & replaces all information previously supplied. For additional information, please visit our website [http:// www.21yangjie.com](http://www.21yangjie.com) , or consult your nearest Yangjie's sales office for further assistance.